

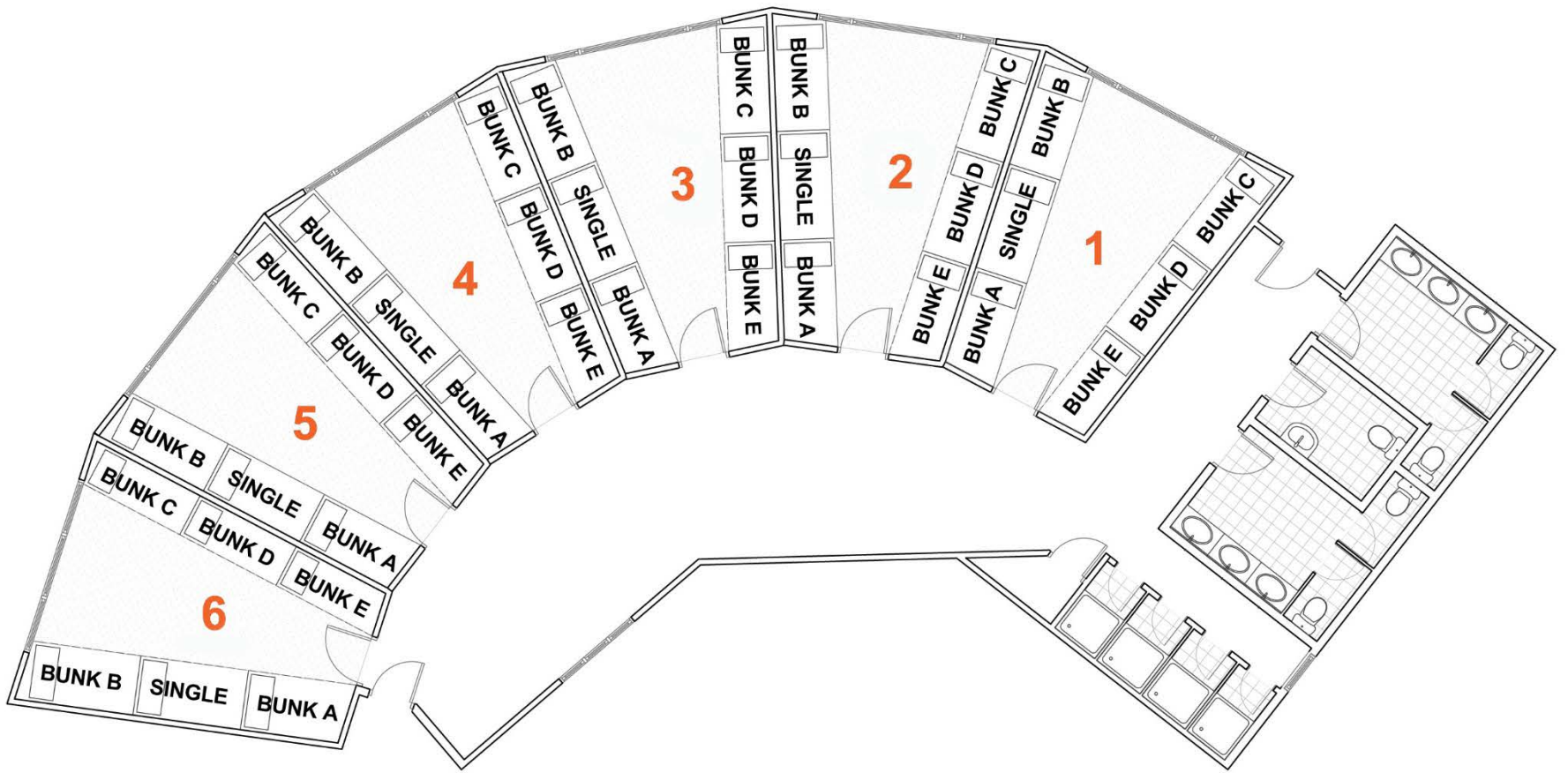

RANCHO
POPLAR LODGE
 Sleeps 66 People



PLEASE FILL IN THE NAMES OF THE PEOPLE ALLOCATED TO THESE UNITS

CABIN 1

Bunk A Upper: _____
 Bunk A Lower: _____
 Bunk B Upper: _____
 Bunk B Lower: _____
 Bunk C Upper: _____
 Bunk C Lower: _____
 Bunk D Upper: _____
 Bunk D Lower: _____
 Bunk E Upper: _____
 Bunk E Lower: _____
 Single: _____

CABIN 2

Bunk A Upper: _____
 Bunk A Lower: _____
 Bunk B Upper: _____
 Bunk B Lower: _____
 Bunk C Upper: _____
 Bunk C Lower: _____
 Bunk D Upper: _____
 Bunk D Lower: _____
 Bunk E Upper: _____
 Bunk E Lower: _____
 Single: _____

CABIN 3

Bunk A Upper: _____
 Bunk A Lower: _____
 Bunk B Upper: _____
 Bunk B Lower: _____
 Bunk C Upper: _____
 Bunk C Lower: _____
 Bunk D Upper: _____
 Bunk D Lower: _____
 Bunk E Upper: _____
 Bunk E Lower: _____
 Single: _____

CABIN 4

Bunk A Upper: _____
 Bunk A Lower: _____
 Bunk B Upper: _____
 Bunk B Lower: _____
 Bunk C Upper: _____
 Bunk C Lower: _____
 Bunk D Upper: _____
 Bunk D Lower: _____
 Bunk E Upper: _____
 Bunk E Lower: _____
 Single: _____

CABIN 5

Bunk A Upper: _____
 Bunk A Lower: _____
 Bunk B Upper: _____
 Bunk B Lower: _____
 Bunk C Upper: _____
 Bunk C Lower: _____
 Bunk D Upper: _____
 Bunk D Lower: _____
 Bunk E Upper: _____
 Bunk E Lower: _____
 Single: _____

CABIN 6

Bunk A Upper: _____
 Bunk A Lower: _____
 Bunk B Upper: _____
 Bunk B Lower: _____
 Bunk C Upper: _____
 Bunk C Lower: _____
 Bunk D Upper: _____
 Bunk D Lower: _____
 Bunk E Upper: _____
 Bunk E Lower: _____
 Single: _____